

WATER IN FUEL CONNECTOR		
#	DESCRIPTION	TERMINATION/CONNECTION POINT
1	WF SENSOR SIGNAL	TO #4 SOCKET CONNECTOR - #44
2	WF SENSOR SUPPLY (+8V)	TO #V SPlice
3	SENSOR RETURN	TO SENSOR RETURN SPlice

COOLANT LEVEL SENSOR		
#	DESCRIPTION	TERMINATION/CONNECTION POINT
A	ANALOG SENSOR POWER (+8V)	TO #V SPlice
B	ANALOG SENSOR RETURN	TO SENSOR RETURN SPlice
C	COOLANT LEVEL SENSOR	TO #4 SOCKET CONNECTOR - #47

GLOW PLUG		
#	DESCRIPTION	TERMINATION/CONNECTION POINT
1	GLOW PLUG	TO GLOW PLUG SPlice

3 PIN RESISTOR		
#	DESCRIPTION	TERMINATION/CONNECTION POINT
J	CAN A (+)	SPliced TO YELLOW WIRE ON J1939 CABLE
K	CAN B (+)	SPliced TO GREEN WIRE ON J1939 CABLE

64 SOCKET CONNECTOR (ENGINE CONNECTION J1)		
#	DESCRIPTION	TERMINATION/CONNECTION POINT
7	CONSTANT VOLTAGE TO ECM	TO CONSTANT VDC SPlice
8	CONSTANT VOLTAGE TO ECM	TO CONSTANT VDC SPlice
15	CONSTANT VOLTAGE TO ECM	TO CONSTANT VDC SPlice
16	CONSTANT VOLTAGE TO ECM	TO CONSTANT VDC SPlice
1	GROUND	TO BATTERY (-) SPlice
2	GROUND	TO BATTERY (-) SPlice
3	GROUND	TO BATTERY (-) SPlice
6	GROUND	TO BATTERY (-) SPlice
10	GROUND	TO BATTERY (-) SPlice
22	J1939 SHIELD	TO J1939 SHIELD SPlice
30	J1939 (+)	TO 12 SOCKET 'B' CONNECTOR - #1 (100 Ω 3PIN A)
31	J1939 (-)	TO 12 SOCKET 'B' CONNECTOR - #9 (100 Ω 3PIN B)
32	CAT DATA LINK (+)	TO 12 SOCKET 'C' CONNECTOR - #6
33	CAT DATA LINK (-)	TO 12 SOCKET 'C' CONNECTOR - #10
34	PWM SENSOR RETURN	TO SENSOR RETURN SPlice
35	SWITCH RETURN	TO SWITCH RETURN SPlice
36	INTERMEDIATE ENGINE SPEED SW	TO 6 POSITION INTERCONNECT - #6
40	SWITCHED VOLTAGE	TO SWITCHED VOLTAGE SPlice
41	PWM SENSOR SUPPLY (+8V)	TO #V SPlice
41	WF SENSOR SIGNAL	TO WATER IN FUEL CONNECTOR - #1
47	COOLANT LEVEL SENSOR	TO 3 SOCKET CONNECTOR - C
48	REMOTE SHUTDOWN SWITCH	TO 12 SOCKET 'B' CONNECTOR - #5
49	PTO DISENGAGE (N/C)	TO 6 POSITION INTERCONNECT - #1
50	THROTTLE UP	TO 6 POSITION INTERCONNECT - #2
51	THROTTLE DOWN	TO 6 POSITION INTERCONNECT - #3
52	PTO ON/OFF	TO 6 POSITION INTERCONNECT - #4
53	PWM THROTTLE INPUT	TO 6 POSITION INTERCONNECT - #5
57	GLOW PLUG COIL (+)	TO 12 SOCKET 'B' CONNECTOR - #2
58	CHECK ENGINE LAMP	TO 6 POSITION INTERCONNECT - #1
60	STOP ENGINE LAMP	TO 6 POSITION INTERCONNECT - #2
61	PTO MODE LAMP	TO 6 POSITION INTERCONNECT - #3
62	LOW OIL PSI LAMP	TO 6 POSITION INTERCONNECT - #4
63	WAIT TO START LAMP	TO 6 POSITION INTERCONNECT - #5

ALT EXCITE #10 RING TERMINAL		
#	DESCRIPTION	TERMINATION/CONNECTION POINT
1	ALT EXCITE (D+)	TO 12 SOCKET 'D' CONNECTOR - #11

STARTER (1/4" RING TERMINAL)		
#	DESCRIPTION	TERMINATION/CONNECTION POINT
1	STARTER (+)	TO 12 SOCKET 'C' CONNECTOR - #8
1	STARTER (+)	TO 12 SOCKET 'C' CONNECTOR - #9

BATTERY (-) LUG		
#	DESCRIPTION	TERMINATION/CONNECTION POINT
1	OND WIRES TO BATTERY (-) LUG	TO BATTERY (-) SPlice

BATTERY (+) LUG		
#	DESCRIPTION	TERMINATION/CONNECTION POINT
1	BATT WIRES TO BATTERY (+) LUG	TO BATTERY (+) SPlice

WATER IN FUEL CONNECTOR

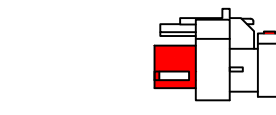

COOLANT LEVEL SENSOR

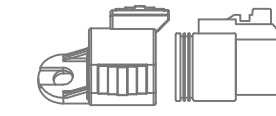

GLOW PLUG
1/4" RING TERMINAL



3 PIN RESISTOR

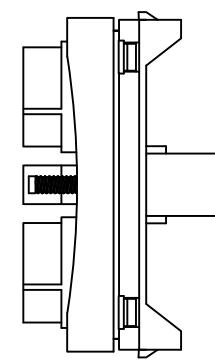
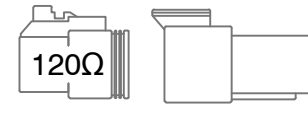

ALT EXCITE
#10 RING TERMINAL



STARTER
1/4" RING TERMINAL



GROUND WIRES
BATTERY (-)



BATTERY WIRES
BATTERY (+)

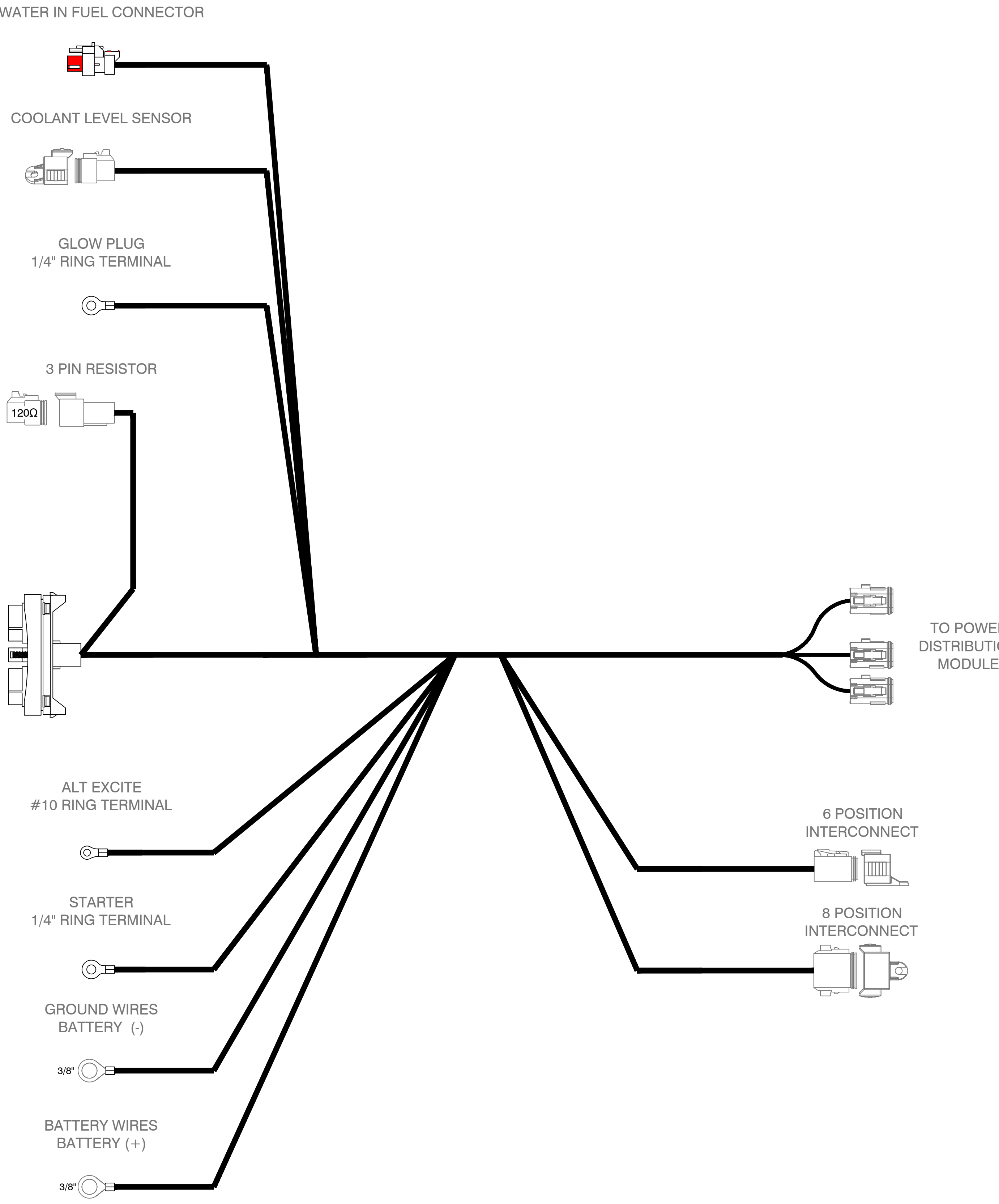

TO GLOW
PLUG POST
ON ENGINE

TO ALT EXCITE
(D+) ON ENGINE

TO STARTER ON
ENGINE

12 SOCKET - CUSTOMER CONNECTOR	
#	DESCRIPTION
1	REMOTE ENGINE SHUTDOWN
2	SW COMMON FROM ECM
3	START SOLENOID
4	EXTERNAL ALARM RELAY OUTPUT
5	CAT DATA LINK HIGH
6	CAT DATA LINK LOW
7	J1939 CAN HIGH
8	J1939 CAN LOW
9	CAN SHIELD
10	KEYSWITCH INPUT
11	CONSTANT VOLTAGE SUPPLY
12	GROUND

12 SOCKET 'C' KEY CONNECTOR (GREEN) - POWER		
#	DESCRIPTION	TERMINATION/CONNECTION POINT
1	BATTERY (+)	TO BATTERY (+) SPlice
2	BATTERY (+)	TO BATTERY (+) SPlice
3	BATTERY (+)	TO BATTERY (+) SPlice
4	BATTERY (+)	TO BATTERY (+) SPlice
5	BATTERY (+)	TO BATTERY (+) SPlice
6	BATTERY (+)	TO BATTERY (+) SPlice
7	BATTERY (+)	TO BATTERY (+) SPlice
8	BATTERY (+)	TO BATTERY (+) SPlice
9	BATTERY (+)	TO BATTERY (+) SPlice
10	BATTERY (+)	TO BATTERY (+) SPlice
11	BATTERY (+)	TO BATTERY (+) SPlice
12	BATTERY (+)	TO BATTERY (+) SPlice

12 SOCKET 'D' KEY CONNECTOR (BROWN) - ENGINE		
#	DESCRIPTION	TERMINATION/CONNECTION POINT
1	GLOW PLUG	TO GLOW PLUG SPlice
2	GLOW PLUG	TO GLOW PLUG SPlice
3	GLOW PLUG	TO GLOW PLUG SPlice
4	GLOW PLUG	TO GLOW PLUG SPlice
5	GLOW PLUG	TO GLOW PLUG SPlice
6	GLOW PLUG	TO GLOW PLUG SPlice
7	GLOW PLUG	TO GLOW PLUG SPlice
8	STARTER (+)	TO STARTER 1/4" RING TERMINAL
9	STARTER (+)	TO STARTER 1/4" RING TERMINAL
10	SWITCHED VOLTAGE	TO SWITCHED VOLTAGE SPlice
11	ALT EXCITE (D+)	TO ALT EXCITE #10 RING TERMINAL

12 SOCKET 'B' KEY CONNECTOR (BLACK) - ENGINE		
#	DESCRIPTION	TERMINATION/CONNECTION POINT
1	GLOW PLUG COIL (+)	TO SWITCHED VOLTAGE SPlice
2	GLOW PLUG COIL (-)	TO #4 SOCKET CONNECTOR - #57
3	CONSTANT VOLTAGE TO ECM	TO CONSTANT VDC SPlice
4	CONSTANT VOLTAGE TO ECM	TO CONSTANT VDC SPlice
5	REMOTE SHUTDOWN SWITCH	TO #4 SOCKET CONNECTOR - #48
6	J1939 (+)	TO #4 SOCKET CONNECTOR - #21 (100 Ω 3PIN B)
7	J1939 (-)	TO #4 SOCKET CONNECTOR - #20 (100 Ω 3PIN A)
8	SWITCH RETURN	TO SWITCH RETURN SPlice
9	CAT DATA LINK (+)	TO #4 SOCKET CONNECTOR - #20
10	CAT DATA LINK (-)	TO #4 SOCKET CONNECTOR - #24

6 POSITION INTERCONNECT		
#	DESCRIPTION	TERMINATION/CONNECTION POINT
1	CHECK ENGINE LAMP	TO #4 POSITION CONNECTOR - #50
2	STOP ENGINE LAMP	TO #4 POSITION CONNECTOR - #50
3	PTO MODE LAMP	TO #4 POSITION CONNECTOR - #51
4	LOW OIL PSI LAMP	TO #4 POSITION CONNECTOR - #52
5	WAIT TO START LAMP	TO #4 POSITION CONNECTOR - #53
6	INTERMEDIATE ENGINE SPEED SW	TO #4 POSITION CONNECTOR - #56

8 POSITION INTERCONNECT		
#	DESCRIPTION	TERMINATION/CONNECTION POINT
1	PTO DISENGAGE (N/C)	TO #4 SOCKET CONNECTOR - #49
2	THROTTLE UP	TO #4 SOCKET CONNECTOR - #50
3	THROTTLE DOWN	TO #4 SOCKET CONNECTOR - #51
4	PTO ON/OFF	TO #4 SOCKET CONNECTOR - #52
5	PWM THROTTLE INPUT	TO #4 SOCKET CONNECTOR - #53
6	SWITCH RETURN	TO SWITCH RETURN SPlice
7	PWM SENSOR SUPPLY (+8V)	TO #V SPlice
8	PWM SENSOR RETURN	TO SENSOR RETURN SPlice

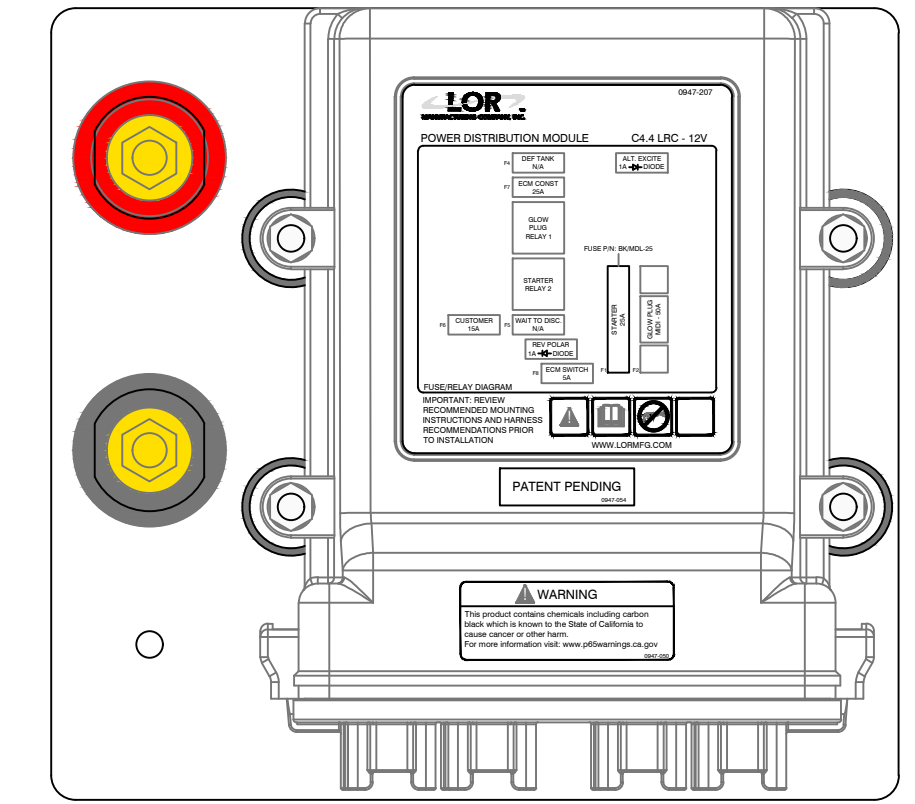

CUSTOMER
CONNECTOR

HARNESS
CONNECTORS

BATTERY CABLES					
WIRE COLOR	GAUGE	DESCRIPTION	TERMINATION/CONNECTION POINT	TOTAL LENGTH	
[1] RED	8 GA.	STARTER TO ALT BATTERY (+)	5/16" RING TERMINAL TO 5/16" RING TERMINAL	32 IN.	
[2] BLACK	8 GA.	STARTER TO ALT BATTERY (-)	1/2" RING TERMINAL TO 1/4" RING TERMINAL	30 IN.	
[3] BLACK	8 GA.	STARTER ENGINE BLOCK (-)	1/2" RING TERMINAL TO 3/8" RING TERMINAL	7 IN.	

